

E45 OPENING WINDOW & DOOR SYSTEM

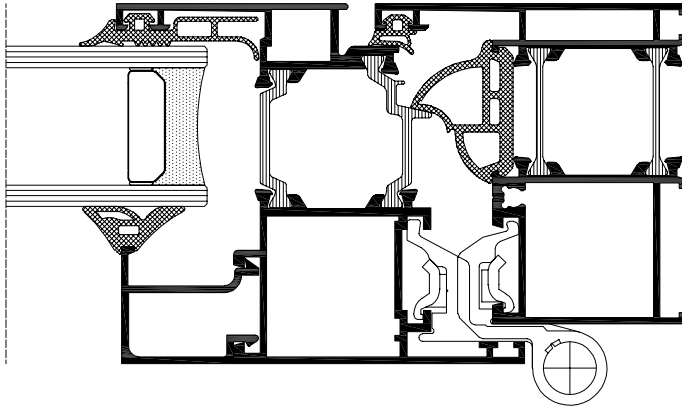

PERFORMANCES

Air permeability:

up to **Class 4**

up to **Class 4**

Watertightness:

up to **Class E1950**

up to **Class 5A**

Resistance to wind load:

up to **Classes AE2500 / C5**

up to **Class C4**

Thermal transmittance (Uf):

from **1.9 W/(m²K)**

from **2.1 W/(m²K)**

Acoustic performance:

up to **50 dB**

Burglar resistance:

up to **Class WK2**

up to **Class WK2**
(one leaf)

TYOLOGIES

- Turn, tilt & turn, tilt, projecting, folding, pivoting, fixed, parallel sliding
- Inwards & outwards opening

- Single & double leaf
- Rectangular, variable angle & bended

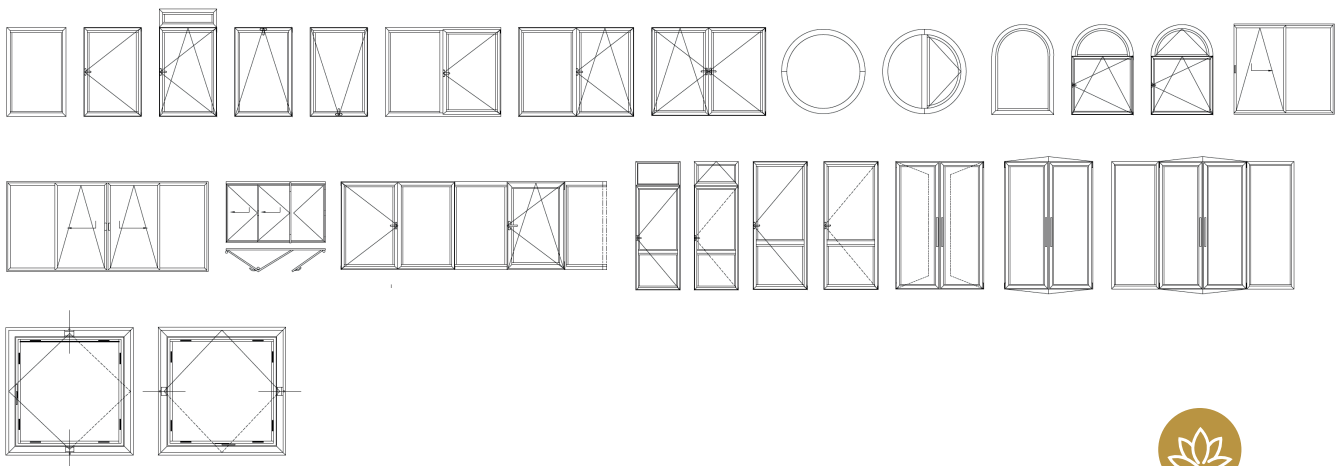

E75 OPENING WINDOW SYSTEM

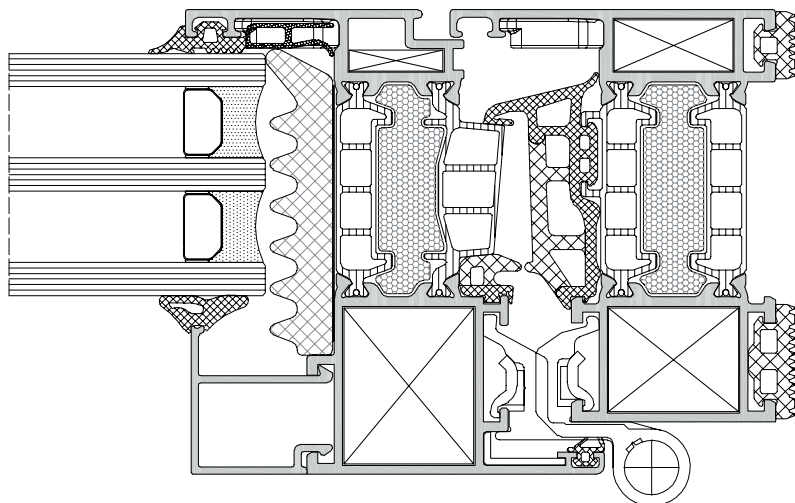

PERFORMANCES

Air permeability:	up to Class 4
Watertightness:	up to Class E1500
Resistance to wind load:	up to Class C5
Thermal transmittance (Uf):	from 1.2 W/(m²K)
Acoustic performance:	up to 46 dB
Burglar resistance:	up to Class RC2

TYOLOGIES

- Turn, tilt & turn, tilt, projecting, folding, fixed, parallel sliding, doorheight window
- Single & double leaf
- Rectangular, variable angle & bended

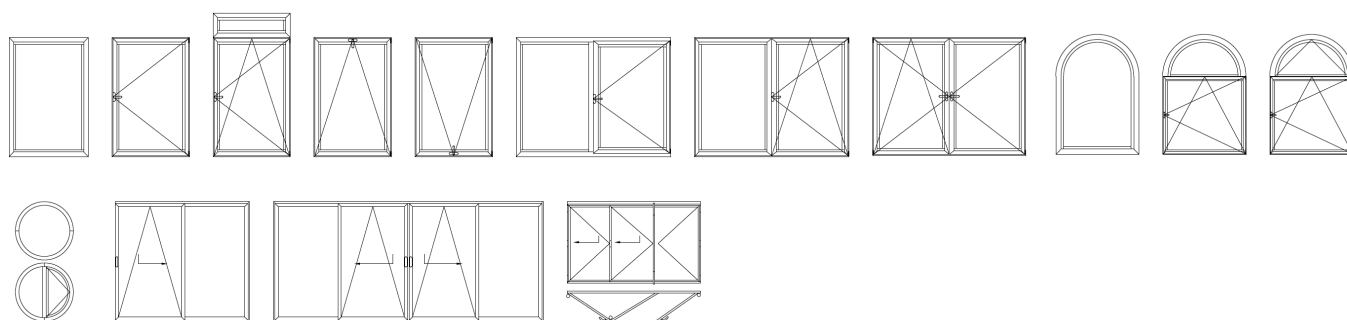

E50 SLIDING SYSTEM

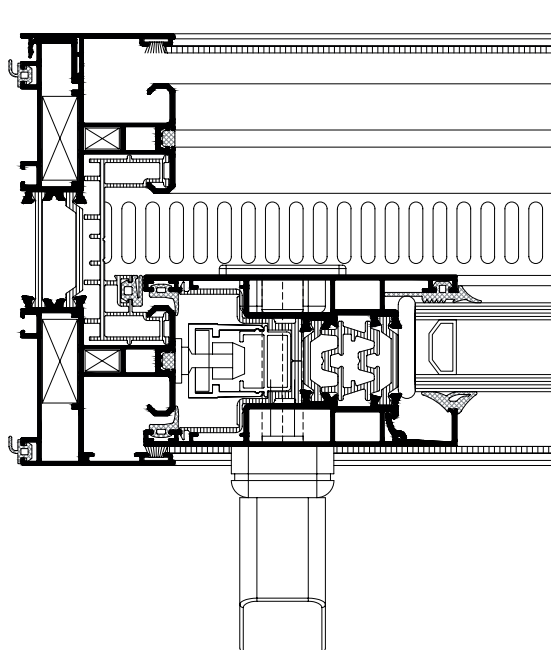

PERFORMANCES

Air permeability:	up to Class 4
Watertightness:	up to Class E1200
Resistance to wind load:	up to Class C3
Thermal transmittance (Uf):	from 2.0 W/(m²K)
Acoustic performance:	up to 41 dB

TYPOLOGIES

- Single, double, triple & quadruple sliding
- Opposed & pocket sliding
- Sliding & fixed
- Hotel type
- Fly screen & sliding shutter incorporated solution

